

If a Ventilator Inoperative alarm occurs, the display screen turns red and the Ventilator Inoperative message appears on-screen, as shown below.



Warning: Immediately remove the patient from the ventilator and if required, connect them to an alternate source of ventilation. Contact your home care equipment provider for service.

Meanwhile, as an option you may follow these steps to try to temporarily restore ventilatory function while waiting for a replacement device and/or professional medical intervention.

1. Power off the therapy device.

- Press the Start/Stop button ().
- If the ventilator display is operational, the “Power Off” confirmation screen will appear, as shown below.

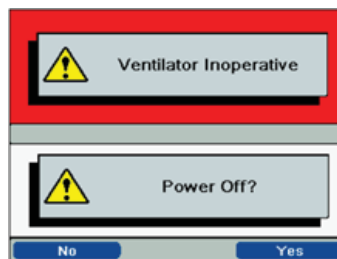

- Select the button on the right side, “Yes” to shut off the device and silence the alarm.

2. Unplug the power cord from the wall or from the device itself.

3. Remove the battery from the therapy device.

Detachable Battery Pack

- If the detachable battery pack is used, open the battery compartment at top of the detachable battery module accessory.
- Lift battery out using release lever on top of the battery (see below).

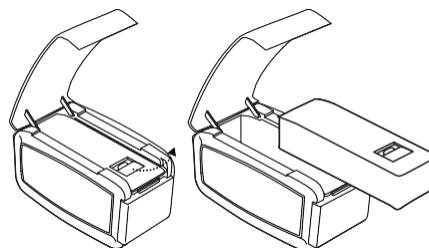

Respironics Inc.
1001 Murry Ridge Lane
Murrysville, PA 15668
USA

Li Ion Battery Pack

- If an external battery pack is used, unplug the battery pack cord from the back of the ventilator (see below).

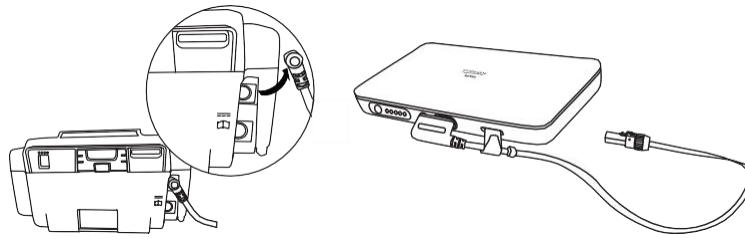

4. Leave the battery disconnected from the ventilator for at least 30 seconds.
5. Reconnect the applicable battery in use.
6. Plug the power cord in to the wall or to the therapy device itself.

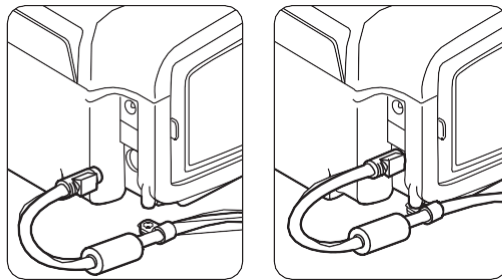

7. Power on the device by pressing the Start/Stop button ().

8. Once the ventilator powers back on, therapy may be restarted.