

Before you get started:

- Your sample must be dropped off on the same day you collect it.
- Make sure you wash your hands!
- Be sure to keep the box that your kit came in. You will use it to return your sample.
- Please read instructions carefully and follow directions step by step.
- **If you are under 18 years old and collecting your own sample**, please ask a parent or guardian to read the instructions and help with returning your kit.
- The soft tip of the swab should **ONLY** go inside your nose. Do not let it touch anything else. If the swab touches any other surface, request a new kit.

Your kit includes:

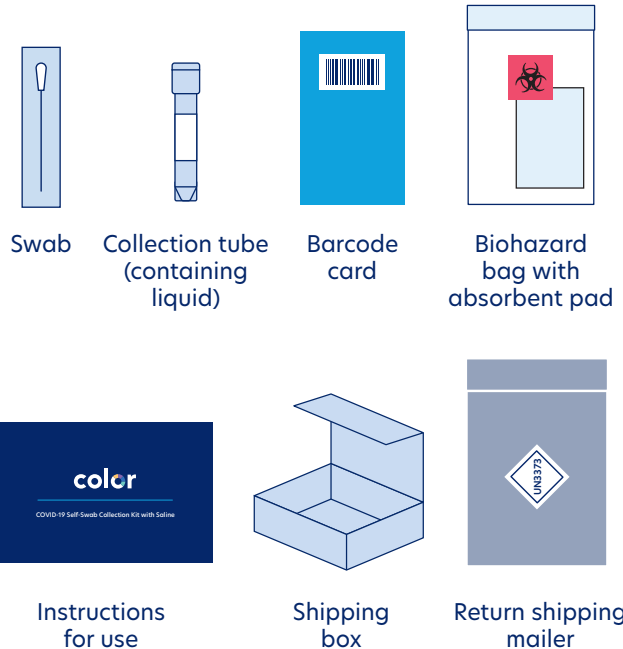

Checklist before returning your kit:

- Did you activate your kit?
- Did you collect a sample from both nostrils?

Visit color.com/sample-return to learn more.

Questions?

Visit support.color.com or contact us at mycovidtest@color.com or (844) 352-6567.

This product has not been FDA cleared or approved, but has been authorized for emergency use by FDA under an EUA;

This product has been authorized only for the home collection and maintenance of anterior nasal swab specimens as an aid in detection of nucleic acid from SARS-CoV-2, not for any other viruses or pathogens; and,

The emergency use of this product is only authorized for the duration of the declaration that circumstances exist justifying the authorization of emergency use of medical devices under Section 564(b)(1) of the Federal Food, Drug and Cosmetic Act, 21 U.S.C. § 360bbb-3(b)(1), unless the declaration is terminated or authorization is revoked sooner.

color

COVID-19 Self-Swab Collection Kit with Saline

At-home Instructions

For prescription use only, For IVD Use, For use under emergency use authorization only, For use by individuals age 18 years and older (self-collected), 14 years and older (self-collected under adult supervision), or 2 years and older (collected with adult assistance)

color

1

Activate your kit online at color.com/covid/activate.

You need your unique barcode, which you'll find on your collection tube.



Warning: Your sample will not be tested if the kit is not activated. If you are under 18, please ask a parent or guardian to help with returning your kit.

2

Before collecting your sample, wash your hands thoroughly for 20 seconds and dry them well.

3

Unscrew the cap of the collection tube.

Keep the cap nearby. The collection tube should be kept upright, so you don't spill any of the liquid. Do not drink the liquid.

Note: You can put the tube in a jar or glass to keep it upright.



4

Open the swab package.

Starting from the handle end of the swab package, peel open the paper backing. Pull swab out of its packaging by the handle.

Note: Do not touch the soft tip with your hands or lay it down on any surface.

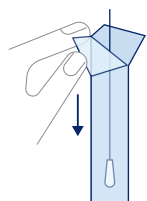

5

Rotate swab tip in first nostril, 4 times.

Insert the soft tip into one nostril, until it is no longer visible. Using medium pressure against the inside of your nostril the whole time, rub the swab in a large circular motion at least 4 times.

Note: Insert less than 1 inch into the nostril for adults and less than 1/2 an inch for younger children.

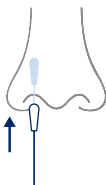

6

Rotate swab tip in other nostril, 4 times.

Repeat the previous step in the second nostril, using the same end of the swab.

Note: You will use the same swab for both nostrils.

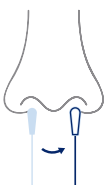

7

Put swab into the collection tube.

The soft tip of the swab that went into your nose should go into the tube first.



8

Screw the cap of the collection tube firmly closed.

You're almost done! Make sure the top is closed tightly.

Note: After closing the collection tube, wash your hands thoroughly for 20 seconds and dry them well.



9

Put collection tube into the biohazard bag.

Do NOT remove the absorbent pad. Seal the biohazard bag closed.

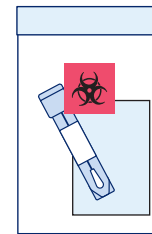

10

Put biohazard bag into the shipping box.

Seal the shipping box closed.

Note: Use the same box that your kit came in.

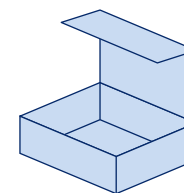

11

Put box into the return shipping mailer.

Seal the return shipping mailer closed. Your return shipping has already been paid.

Note: This packaging is specially designed for shipping samples suspected of carrying infectious substances. Do NOT replace it.



12

Return kit.

Your sample must be returned on the same day you collect it.

Note: If you aren't able to return your sample on the same day, contact mycovidtest@color.com.

Before you get started:

- Your sample must be dropped off on the same day you collect it.
- **Make sure there is a collection today.** Refer to your program details if you're not sure where to return your sample.
- **Don't miss the last pickup.** Refer to your program details for pickup times.
- Make sure you wash your hands!
- Please read instructions carefully and follow directions step by step.
- **If you are under 18 years old and collecting your own sample,** please ask a parent or guardian to read the instructions and help with returning your kit.
- The soft tip of the swab should **ONLY** go inside your nose. Do not let it touch anything else. If the swab touches any other surface, request a new kit.

Checklist before returning your kit:

- Did you activate your kit?
- Did you collect a sample from both nostrils?

Visit color.com/sample-return to learn more.

Questions?

Visit support.color.com or contact us at mycovidtest@color.com or (844) 352-6567.

This product has not been FDA cleared or approved, but has been authorized for emergency use by FDA under an EUA;

This product has been authorized only for the home collection and maintenance of anterior nasal swab specimens as an aid in detection of nucleic acid from SARS-CoV-2, not for any other viruses or pathogens; and,

The emergency use of this product is only authorized for the duration of the declaration that circumstances exist justifying the authorization of emergency use of medical devices under Section 564(b)(1) of the Federal Food, Drug and Cosmetic Act, 21 U.S.C. § 360bbb-3(b)(1), unless the declaration is terminated or authorization is revoked sooner.



COVID-19 Self-Swab Collection Kit with Saline

On-site Instructions

For prescription use only, For IVD use, For use under emergency use authorization only, For use by individuals age 18 years and older (self-collected), 14 years and older (self-collected under adult supervision), or 2 years and older (collected with adult assistance)

Your kit includes:



Swab



Collection tube
(containing liquid)



Barcode
card

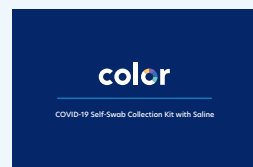

Instructions
for use



Biohazard
bag

1

Activate your kit online at color.com/covid/activate.

You need your unique barcode, which you'll find on your collection tube.



Warning: Your sample will not be tested if the kit is not activated. If you are under 18, please ask a parent or guardian to help with returning your kit.

2

Before collecting your sample, wash your hands thoroughly for 20 seconds and dry them well.

3

Unscrew the cap of the collection tube.

Keep the cap nearby. The collection tube should be kept upright, so you don't spill any of the liquid. Do not drink the liquid.

Note: You can put the tube in a jar or glass to keep it upright.

4

Open the swab package.

Starting from the handle end of the swab package, peel open the paper backing. Pull swab out of its packaging by the handle.

Note: Do not touch the soft tip with your hands or lay it down on any surface.

5

Rotate swab tip in first nostril, 4 times.

Insert the soft tip into one nostril, until it is no longer visible. Using medium pressure against the inside of your nostril the whole time, rub the swab in a large circular motion at least 4 times

Note: Insert less than 1 inch into the nostril for adults and less than 1/2 an inch for younger children.

6

Rotate swab tip in other nostril, 4 times.

Repeat the previous step in the second nostril, using the same end of the swab.

Note: You will use the same swab for both nostrils.

7

Put swab into the collection tube.

The soft tip of the swab that went into your nose should go into the tube first.

8

Screw the cap of the collection tube firmly closed.

You're almost done! Make sure the top is closed tightly.

Note: After closing the collection tube, wash your hands thoroughly for 20 seconds and dry them well.

9

Put collection tube into the biohazard bag.

Seal the biohazard bag closed.

10

Bring the biohazard bag to your designated test collection point.

Refer to your program details if you're not sure where to return your sample.

Note: Don't miss the last pickup time.