

Return Instructions

Double check that you registered your sample at everlywell.com/register and added the ID sticker with your information to the sample tube.

1

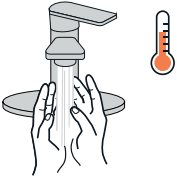

Wash your hands

Wash your hands thoroughly with soap and water for 20 seconds.

2



Get return box ready

Assemble the box (insert flaps or pop open) and close one end.

3



Prepare sample

Place your biohazard bag inside the box. The box provides extra protection during transit.

4

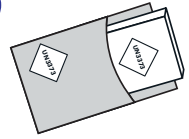

Put box in mailer

With clean hands, place the shipping box into the prepaid mailer. Apply the shipping label to the front of the mailer. **Do not cover the UN3373 label.**

5



Alcohol prep pad



Disinfect the mailer

Use the provided alcohol prep pad to disinfect the mailer, avoiding the address label, before completing the final shipping step.

6

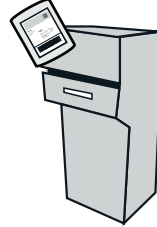

Ship

Deliver the pre-paid, pre-addressed return pack to a UPS drop box. It's important you drop off your sample on the **same day you collect before the last pickup** for overnight shipping. **Do not deliver sample to a drop box on the weekend.**

IS-EW-CVD19-003

This product has not been FDA cleared or approved, but has been authorized for emergency use by FDA under an EUA. This product has been authorized only for the home collection and maintenance of nasal swab specimens as an aid in detection of nucleic acid from SARS-CoV-2, not for any other viruses or pathogens. The emergency use of this product only authorized for the duration of the declaration that circumstances exist justifying the authorization of emergency use of medical devices under Section 564(b)(1) of the Federal Food, Drug and Cosmetic Act, 21 U.S.C. § 360bbb-3(b)(1), unless the declaration is terminated or authorization is revoked sooner.

everlywell.com/orders

Check the status of your order any time by going to

network for next steps.

3. We'll email you as soon as your results arrive. If positive results are shown, you will be contacted by our independent physician

transmit them to us.

2. A board-certified physician will review your results and securely

any issues.

1. Once your sample is received, the lab will process your sample, assuming it passes all quality checks. We'll contact you if there are

What's next?

COVID-19 Test Home Collection Kit DTC

Instructions

Your kit includes:



Swab and tube



Kit ID stickers



Biohazard bag with absorbent sheet



Alcohol prep pad



Return box

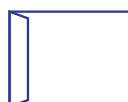

Return envelope



Return label



Instructions and fact sheet for individuals

IVD

For Use Under Emergency Use Authorization

Questions?

support.everlywell.com



+1 855-463-1670



covid19@everlywell.com



Important Reminder

Be sure to complete these 3 steps before mailing your kit.

Register kit



Fill out kit ID sticker

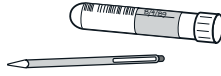

Same day ship



Visit www.everlywell.com/register and complete your registration.

The lab **can only** process your sample if you:

- Register your sample at everlywell.com/register
- Fill out ID sticker and place it on your sample tube
- Ship sample the same day you collect (Monday-Friday)

Sample Collection Instructions

Please follow all instructions closely to ensure proper precautions are taken for packaging and sending COVID-19 samples to our collection labs. Make sure you can ship the same day you collect.

1



Register

You must register your kit at everlywell.com/register before you collect. Do not register until you are ready to collect your sample because you will be asked to enter your time of collection. Collect Monday-Friday as samples cannot be shipped on the weekend. The lab cannot process your sample if this step is missed.

2



Watch video

For best results, watch our collection video at everlywell.com/collect before you start.

3



Locate UPS drop box

Visit the UPS website to view drop box locations and pick up schedules. **Plan to collect and drop off your sample to the drop box on the same day (Monday-Friday) before the last pickup.** Shipping materials are under the green box.

4



Fill out kit ID sticker

Place ID sticker on the collection tube. Do not cover the barcode sticker already on the tube. Using a ballpoint pen or fine tip permanent marker, write your full name, date of birth, and the date of collection. Your information **must** match what you used to register your kit. **Do not pour the liquid out of the tube.**

5

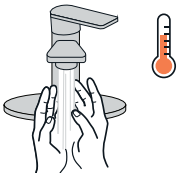

Prep space and wash hands

Disinfect surfaces where you will be completing your test. Blow your nose. Then thoroughly wash your hands with soap and water for 20 seconds prior to collection.

6



Prepare to collect

Before inserting the swab, locate the perforation on the swab (near the tip) as you will need this after you collect your sample. Then tilt your head back to approximately a 45 degree angle.

7

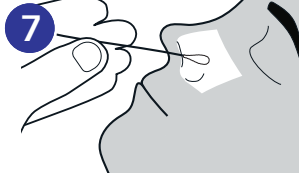

Insert nasal swab

Hold the swab below the perforation line. Gently and slowly insert the swab into your nostril, **about 1 inch** until gentle resistance is met.

8

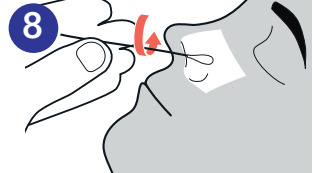

Collect swab sample

Rotate the swab 3 times all the way around the nasal wall with a slight pressure. Remove swab. **Repeat this process in the other nostril using the same swab.**

9

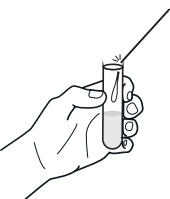

Place the swab sample in the tube

Place the swab sample (tip down) in the tube without spilling the liquid. Break the swab at the perforated line (near the tip) and leave in tube. **Tightly seal cap.** Liquid volume may not completely cover the swab tip.

10



Place tube into bag

Place tube into protective biohazard bag with the absorbent sheet. **Follow return instructions on the reverse.**

What's next? →



IVD
Everlywell
Austin, TX

Email: covid19@everlywell.com
Toll Free: +1 855-463-1670

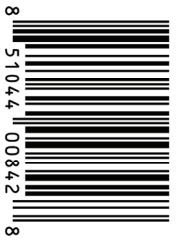

COVID-19 Test Home Collection Kit - DTC

Physician-reviewed test results, fast and easy-to-read results, all from the comfort of your home.



Register Kit



Collect Sample & Ship



Receive Fast Online Results

IVD For Use Under Emergency Use Authorization

Overnight shipping to lab included



COVID-19 Test Home Collection Kit - DTC

Physician-reviewed test results, fast and easy-to-read results, all from the comfort of your home.

www.everlywell.com



SLV-EVW-CV #002

*Must be 18+ to use. Check everlywell.com/states to check what states this test is valid in. Requires access to the internet and an email account. Store kit at room temperature (4-20°C) until sample collection. This product has not been FDA cleared or approved, but has been authorized for emergency use by FDA under an EUA. This product has been authorized only for the home collection and maintenance of nasal swab specimens as an aid in detection of nucleic acid from SARS-CoV-2, not for any other viruses or pathogens. The emergency use of this product only authorized for the duration of the declaration that circumstances exist justifying the authorization of emergency use of medical devices under Section 564(b)(1) of the Federal Food, Drug and Cosmetic Act, 21 U.S.C. § 360bbb-3(b)(1), unless the declaration is terminated or authorization is revoked sooner.

Warnings and Limitations

Contents

- Swab and Tube
- Alcohol Prep Pad
- Kit ID Stickers
- Biohazard Bag with Absorbent Sheet
- Return Box
- Return Envelope
- Return Label
- Instructions and Fact Sheet for Individuals

Register
Register your kit online at everlywell.com/register by entering the unique kit ID found within this package.

Collect
You will collect your sample at home using the collection instructions included in this package and then mail your sample directly to our CLIA-certified lab partner.

Review
If positive results are shown, you will be contacted by our independent physician network for next steps.

Why EverlyWell?

- Convenient**
Complete your sample collection from home.
- Save Time + Money**
Your time is valuable, own your health from home.
- Actionable**
Insights you can understand with tailored advice on your next steps.
- Authorized**
CLIA-certified labs. Physician-reviewed results.

Your Sample Will Be Tested For:

The presence or absence of RNA from SARS-CoV-2 virus

