

## Your kit includes:



Barcode card



Swab and collection tube



Biohazard bag

1

Activate your kit online at [color.com/covid-activate](https://color.com/covid-activate).

You will need the barcode found in your kit. Look for the blue card.



**Warning:** Your sample will not be tested if the kit is not activated.

2

Wash your hands thoroughly for 20 seconds then dry your hands before starting the collection.

3

Unscrew the lid of the collection tube.

Keep the lid nearby.

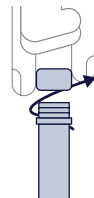

5

Rotate swab tip in first nostril, 3 times.

Insert it into one nostril just until the soft tip is no longer visible, about 1 inch. Rotate it in a circle around the inside edge of your nostril at least 3 times.

**Note:** Do not force the swab any further.

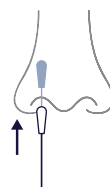

4

Open the swab package.

Starting from the handle end of the swab package, peel open the paper backing. Pull swab out of its packaging by the handle.

**Note:** Do not touch the soft tip with your hands or lay it down on any surface.

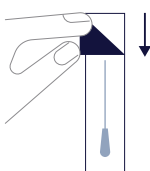

6

Rotate swab tip in other nostril, 3 times.

Repeat the previous step in the second nostril, using the same end of the swab.

**Note:** You will use the same swab for both nostrils.

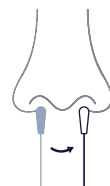

7

Put swab into the collection tube.

The soft tip of the swab that went into your nose should go into the tube first.

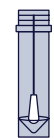

9

Put collection tube into the biohazard bag.

Close the bag with the adhesive seal.

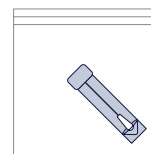

8

Screw on the top of the collection tube.

You're almost done! Make sure the top is screwed on tightly.

**Note:** Wash your hands thoroughly for 20 seconds then dry your hands before packaging the collected sample.

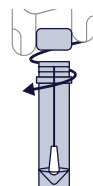

10

Bring the biohazard bag to your designated test collection point.

Your COVID-19 test collector will show you where to deposit your sample.

**Note:** If you miss today's last pickup time, ask your COVID-19 test collector for a new kit.

## Before you get started:

---

- Your sample must be dropped off at your designated test collection point on the same day you collect it.
- **Make sure there is a collection today.** Check with your COVID-19 test collector that samples will be accepted today.
- **Don't miss the last pickup.** Check with your COVID-19 test collector on the latest collection time.
- Make sure you wash your hands!

## Checklist before returning your kit:

- Did you activate your kit?
- Did you collect a sample from both nostrils?

Visit [color.com/sample-return](https://color.com/sample-return) to learn more.

---

## Questions?

Visit [support.color.com](https://support.color.com) or contact us at [support@color.com](mailto:support@color.com) or (844) 352-6567.

For Rx Use Only, For IVD Use Only, For Emergency Use Authorization Only  
This home collection kit has not been FDA cleared or approved. This home collection kit has been authorized by FDA under an EUA.

This home collection kit has been authorized only for the home collection and maintenance of nasal specimens as an aid in detection of nucleic acid from SARS-CoV-2, not for any other viruses or pathogens.

This home collection kit is only authorized for the duration of the declaration that circumstances exist justifying the authorization of emergency use of in vitro diagnostics for detection and/or diagnosis of COVID-19 under Section 564(b)(1) of the Act, 21 U.S.C. § 360bbb-3(b)(1), unless the authorization is terminated or revoked sooner.

# color

---

## COVID-19 Test Unmonitored Collection Kit

On-site Instructions

color

For In Vitro Diagnostic Use, For Rx only, For Use Under Emergency Use Authorization Only